

## STEP 1: Strip Cable

- (1) Strip cable jacket. Cut out braiding and Aluminum foil, only keep drain wire
  - (2) Strip the Aluminum foil of 5 Twisted Pairs (TP) per illustrated dimensions
- ➔ Among 5 TPs, four with blue foil are for TMDS data, and one with silver-colored foil is for Ethernet and Audio Return Channel (HEAC). It is important to keep the foil length of HEAC pair 6mm for easy installation in the following steps.

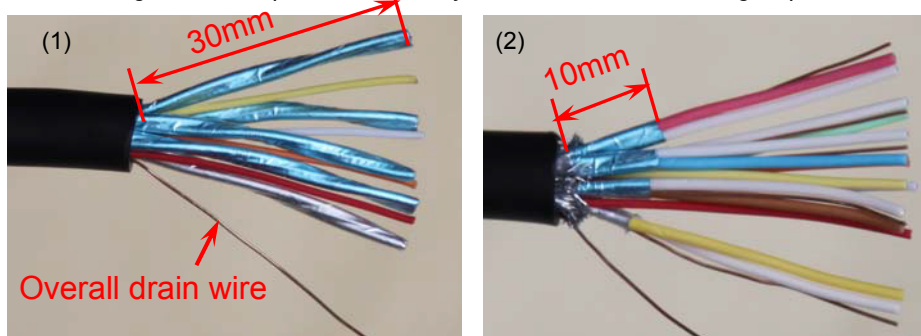

## STEP 2: Insert Wires

- (1) Arrange the wires for 10-hole holder per the pin assignment in the next page, cut the wires at an angle for easy insertion
- (2) Insert the wires into 10-hole holder in one step.
  - ➔ You can divide 10 wires into two groups and insert them in two steps before you are skillful.
- (3) Arrange the wires for 9-hole holder and insert the wires into the holder.
  - ➔ It is very **IMPORTANT** to keep two holders in alignment.

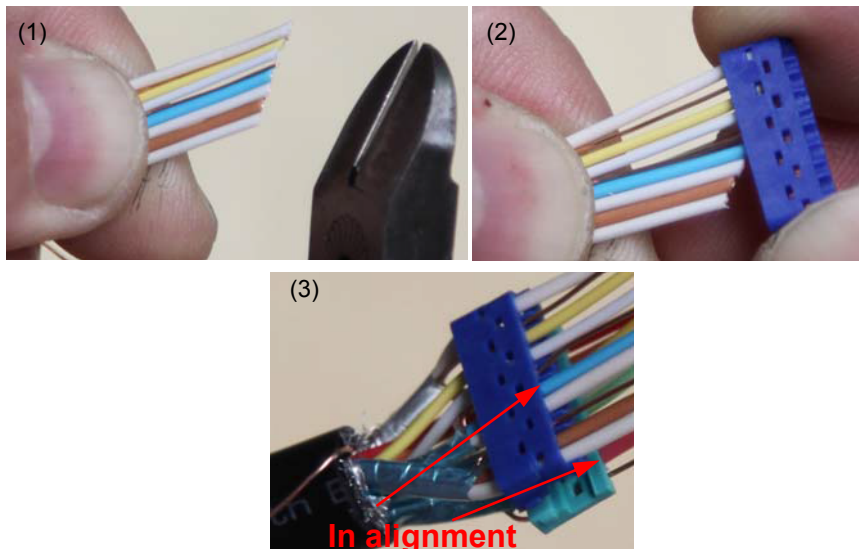

## Pin Assignment

Any mis-wiring, even an intercrossing of Twisted Pairs, will lead to transmission failure. So it is **EXTREMELY VITAL** to make sure the wire assignment correct without any error !!!

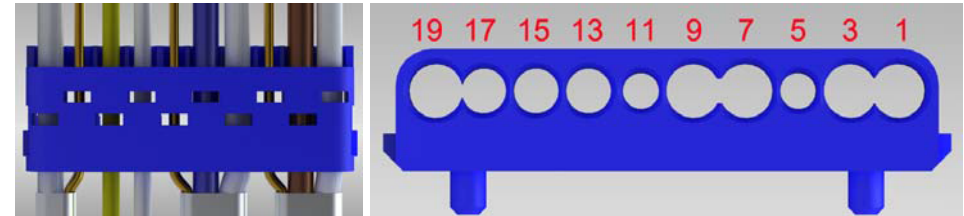

Pin #	19	17	15	13	11	9	7	5	3	1
wires	Twisted Pair w/silver foil		yellow	White	Twisted Pair with blue wire			Twisted Pair With brown wire		
	White	Drain			Drain	Blue	White	Drain	Brown	White

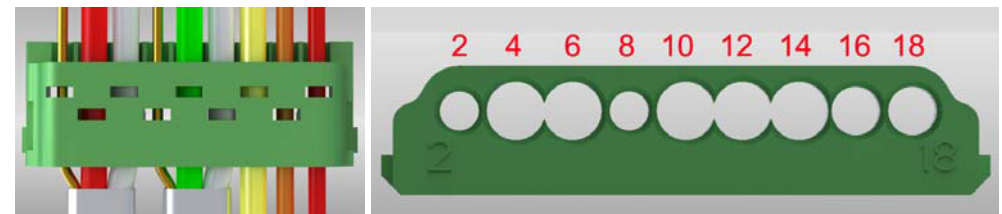

Pin #	2	4	6	8	10	12	14	16	18
wires	Twisted Pair with red wire			Twisted Pair with green wire			Yellow of silver TP	Orange	Red
	Drain	Red	white	Drain	Green	White			

Patented connector and hand tool, all rights reserved.

## STEP 3: Compress

- (1) Install a connector into the guiding jig (the black piece)
- (2) Install and press the holders into the guiding jig.
  - ➔ The 10-hole blue holder is for 10-pin side of HDMI connector and the 9-hole green holder for 9-pin side.
  - ➔ Press two holders with thumb until they lock with the connector
- (3) Insert the assembly into the hand tool
- (4) Compress the tool
- (5) Finished! Excessive wires are cut out automatically.

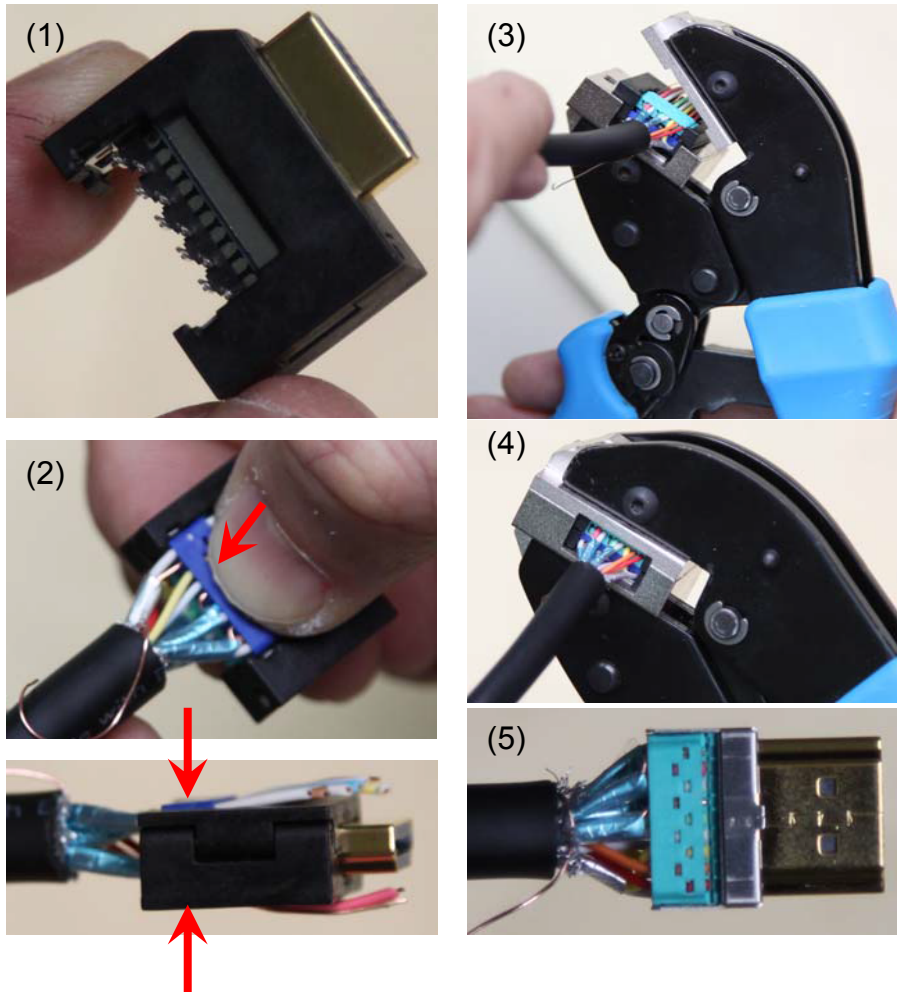

## STEP 4: Install Shell

- (1) Put the connector into the bottom half of the die-cast metal shell.
- (2) Install the metal belt to fasten the cable onto the metal shell. Make sure the drain wire be under the metal belt for grounding.
- (3) Keep the red wire clear of the screw hole, Install the upper half and two screws to finish the whole procedure.



## STEP 5: Test

Test the cable with a portable tester (inc.).

### IMPORTANT

Please use our specially designed HDMI cables included.

We have no guarantee that this connector works with the cables other than our cables due to the big differences in conductor gauge, construction, insulation material, thickness, eccentricity ratio, foaming consistence, twisting parameters, impedance consistence and match. Any incompilance of the above is likely to result in continuity failure.

Besides this printed brief manual, both a detailed PowerPoint file and a MP4 video demo are available on the Doss website: [www.doss.com.au](http://www.doss.com.au)